

REASSEMBLY

1. PLACE RECTIFIER END FRAME ON PULLEY
2. INSTALL ROTOR TO DRIVE END FRAME

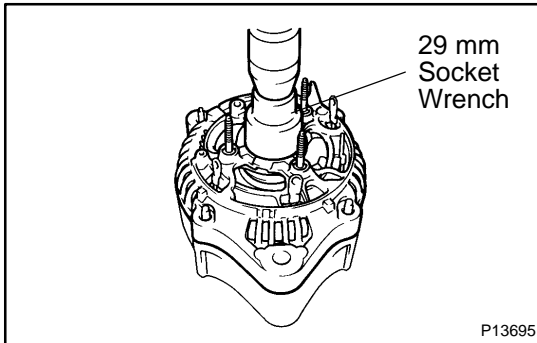

3. INSTALL RECTIFIER END FRAME

- (a) Install the generator washer to the rectifier end frame.

NOTICE:

Be careful of the generator washer installation direction.

- (b) Using a 29 mm socket wrench and press, slowly press in the rectifier end frame.
- (c) Install the 4 nuts.

Torque: 4.5 N·m (45 kgf·cm, 39 in.-lbf)

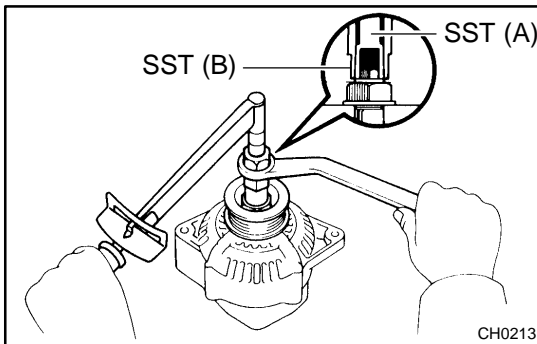

4. INSTALL PULLEY

- (a) Install the pulley to the rotor shaft by tightening the pulley nut by hand.
- (b) Hold SST (A) with a torque wrench, and tighten SST (B) clockwise to the specified torque.

SST 09820-6301 1

Torque: 39 N·m (400 kgf·cm, 29 ft-lbf)

- (c) Check that SST (A) is secured to the pulley shaft.

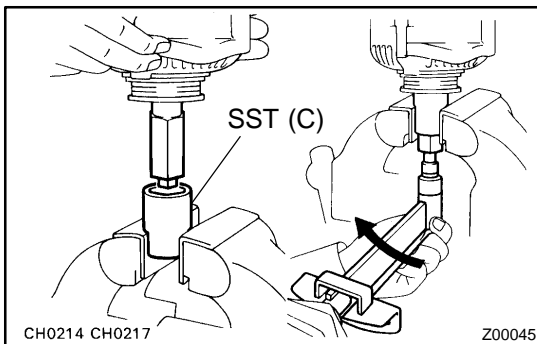

- (d) As shown in the illustration, mount SST (C) in a vise, and install the generator with SST (A) and (B) to SST (C).
- (e) To torque the pulley nut, turn SST (A) in the direction shown in the illustration.

Torque: 110 N·m (1,125 kgf·cm, 81 ft-lbf)

- (f) Remove the generator with SST (A) and (B) from SST (C).
- (g) Turn SST (B) and remove SST (A) and (B).

5. INSTALL RECTIFIER HOLDER

- (a) Install the 4 rubber insulators on the lead wires.
- (b) Install the rectifier with the 4 screws.

Torque: 2.0 N·m (20 kgf·cm, 18 in.-lbf)

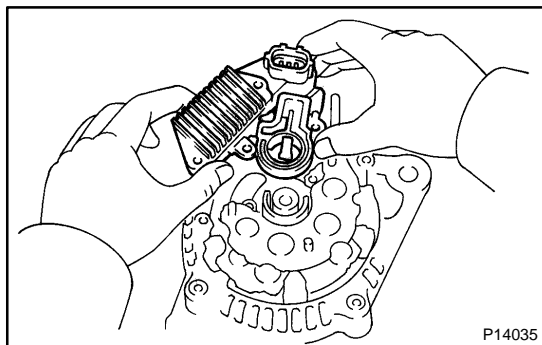

6. INSTALL BRUSH HOLDER AND VOLTAGE REGULATOR

- (a) Place the brush holder cover to the brush holder.
- (b) Install the voltage regulator and brush holder to the rear end frame horizontally as shown in the illustration.

HINT:

Check that the brush holder's cover doesn't slip to one side during installation.

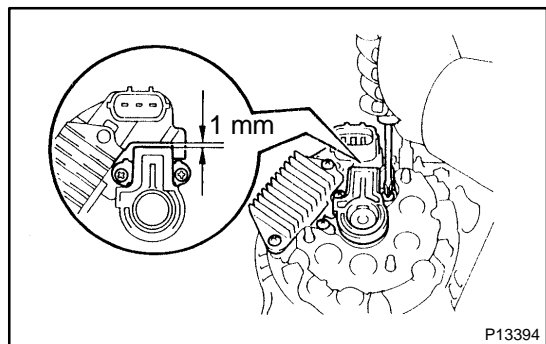

- (c) Tighten the 5 screws until there is a clearance of at least 1 mm (0.04 in.) between the brush holder cover and connector.

7. INSTALL REAR END COVER

- (a) Install the end cover with the 3 nuts.
Torque: 4.5 N·m (45 kgf·cm, 39 in.-lbf)
- (b) Install the terminal insulator with the nut.
Torque: 4.1 N·m (42 kgf·cm, 36 in.-lbf)

8. MAKE SURE ROTOR ROTATES SMOOTHLY